



# User Manual

## ViSAGE<sup>®</sup> GROOMING KIT



# Contents

<b>Overview .....</b>	<b>3</b>
<b>Use.....</b>	<b>4</b>
<b>Package contents/device parts .....</b>	<b>5</b>
<b>General information .....</b>	<b>6</b>
Reading and storing the user manual.....	6
Explanation of symbols .....	6
<b>Safety.....</b>	<b>8</b>
Proper use.....	8
Safety instructions.....	9
<b>Checking the grooming kit and pack contents .....</b>	<b>15</b>
<b>Charging .....</b>	<b>16</b>
Preparing the charging station .....	16
Charging the hair trimmer .....	17
<b>Operation .....</b>	<b>18</b>
<b>Changing the trimmer attachments.....</b>	<b>20</b>
<b>Changing the comb attachments .....</b>	<b>20</b>
<b>Choosing the correct attachment .....</b>	<b>21</b>
Hair trimmer attachment .....	21
Beard trimmer attachment.....	21
Contour trimmer attachment .....	22
Shaver attachment.....	23
Nose/ear hair trimmer attachment .....	23
<b>Cleaning.....</b>	<b>24</b>
Cleaning the charging station.....	25
Cleaning the comb attachments .....	25
Cleaning the hair, beard and contour trimmer attachment.....	26
Cleaning the shaver attachment .....	27
Cleaning the nose/ear hair trimmer attachment .....	28
<b>Troubleshooting .....</b>	<b>28</b>
<b>Travel guard .....</b>	<b>29</b>
Activating the travel guard.....	29
Deactivating the travel guard .....	30
<b>Storage .....</b>	<b>30</b>
<b>Technical data .....</b>	<b>30</b>
<b>Declaration of conformity .....</b>	<b>31</b>
<b>Disposal .....</b>	<b>31</b>
Disposing of the packaging .....	31
Disposing of the grooming kit.....	32

A

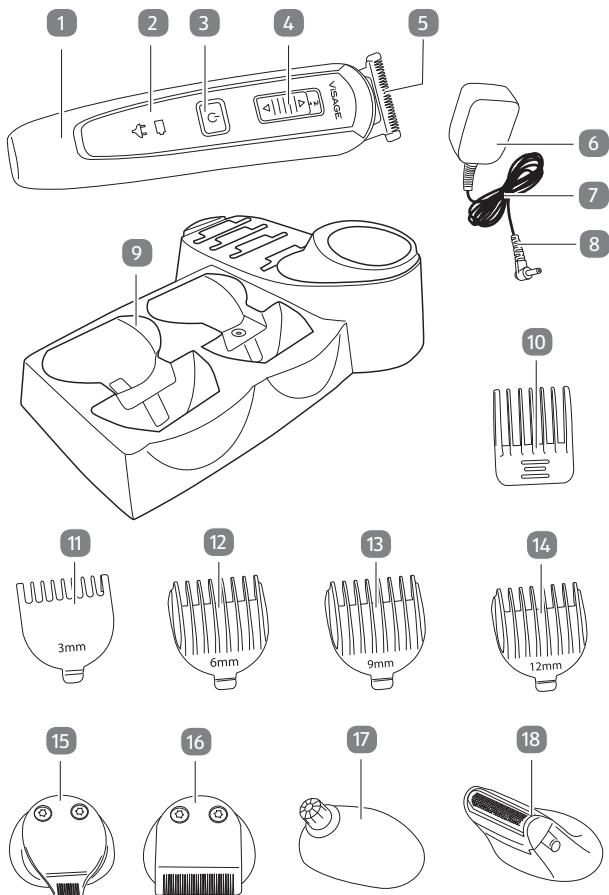

B

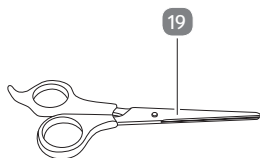

C

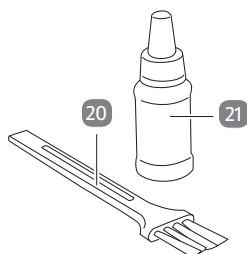

D

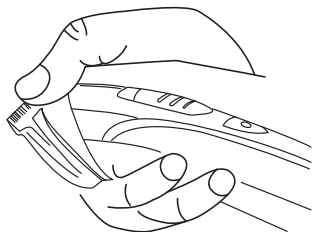

E

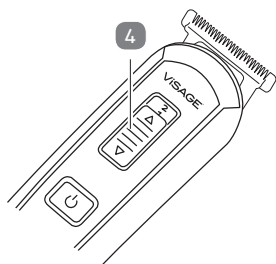

F

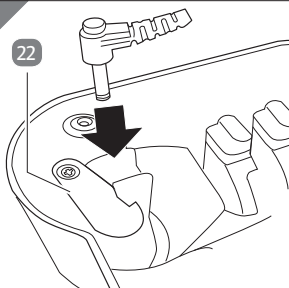

G

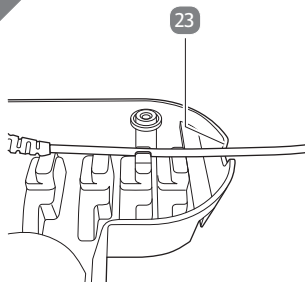

## Package contents/device parts

- 1 Hair trimmer
- 2 LED indicator symbols
- 3 On/Off switch
- 4 Sliding switch for fine adjustment
- 5 Hair trimmer attachment
- 6 AC adapter plug
- 7 Mains cord
- 8 Barrel plug
- 9 Charging station
- 10 Comb attachment for the beard trimmer attachment  
3, 4, 5, 6 mm
- 11 Comb attachment for the hair trimmer attachment 3 mm
- 12 Comb attachment for the hair trimmer attachment 6 mm
- 13 Comb attachment for the hair trimmer attachment 9 mm
- 14 Comb attachment for the hair trimmer attachment 12 mm
- 15 Contour trimmer attachment
- 16 Beard trimmer attachment
- 17 Nose/ear hair trimmer attachment
- 18 Shaver attachment
- 19 Scissors
- 20 Cleaning brush
- 21 Blade oil
- 22 Locking mechanism
- 23 Oval recess

## General information

### Reading and storing the user manual



This user manual accompanies this grooming kit. It contains important information on start-up and handling.

Before using the grooming kit, read the user manual carefully. This particularly applies to the safety notes. Non-observance of this user manual may cause damage to the grooming kit.

The user manual is based on the standards and rules in force in the European Union. When abroad, you must also observe country-specific laws and guidelines.

Store the user manual for future use. Make sure to include this user manual when passing the grooming kit on to third parties.

### Explanation of symbols

The following symbols and signal words are used in this user manual, on the grooming kit or on the packaging.



This symbol/signal word designates a hazard with moderate degree of risk which may lead to death or severe injury if not avoided.

**CAUTION!**

This signal symbol/word designates a hazard with low risk that, if not avoided, may result in minor or moderate injury.

**NOTICE!**

This signal word warns against potential damages to property.



This symbol provides you with useful supplementary information on assembly or operation.



Declaration of conformity (see chapter “Declaration of conformity”): Products marked with this symbol meet all applicable Community regulations for the European Economic Area.



Protection class II; for mains mode (AC adapter plug).



Protection class III; for the device in cordless operation.



The grooming kit is equipped with a short-circuit proof safety transformer.



The grooming kit has a switching power supply.



The grooming kit may only be used in indoor spaces.



This symbol indicates the polarity of the barrel plug: outside (-), inside (+).

## Safety

### Proper use

The grooming kit is exclusively designed for cutting dry, human hair. The grooming kit is only intended for private use and is not suitable for commercial purposes. It may only be used in indoor areas. The grooming kit is not suitable for artificial hair or animal hair.

Only use the grooming kit as described in this user manual. Any other use is considered improper and may result in damage to property.

The manufacturer or vendor accepts no liability for damage caused by improper or incorrect use.



## Safety instructions



### Risk of electric shock!

A faulty electrical installation or excessive mains voltage may result in an electric shock.

- Only connect the grooming kit if the mains voltage of the socket corresponds to the rating plate of the AC adapter plug.
- Only connect the AC adapter plug to an easily accessible socket so that you can quickly disconnect it from the mains in case of a failure.
- If the mains cord, the AC adapter plug or the hair trimmer exhibit visible damages or are defective, do not use them further.
- If the mains cord of the hair grooming kit is damaged, the AC adapter plug including the cord must be replaced by the manufacturer to avoid any risks.
- Only use the grooming kit with the enclosed AC adapter plug.

- Do not open the housing; instead, have a qualified professional perform the repairs. Contact a qualified workshop for this. Liability and warranty claims are waived in the event of repairs performed by the user, improper connection or incorrect operation.
- Only parts that comply with the original device data may be used for repairs. Electrical and mechanical parts, which are essential for providing protection against sources of danger, are located in this device.
- Do not immerse the hair trimmer, the AC adapter plug or mains cord in water or other liquids.
- Keep the grooming kit away from moisture, dripping water and splash water.
- Never touch the AC adapter plug with damp hands.
- Always pull on the AC adapter plug to disconnect it from the socket. Never pull on the mains cord.

- 
- Never use the mains cord as a carrying strap.
  - Only connect the AC adapter plug to the socket if the hair trimmer is connected with the barrel plug.
  - Keep the hair trimmer, the AC adapter plug and mains cord away from open flames and hot surfaces.
  - Lay the mains cord so that it does not pose a tripping hazard.
  - Do not kink the mains cord and do not lay it over sharp edges.
  - Never store the grooming kit so that there is a risk of it falling in water.
  - Never reach to retrieve an electrical device if it has fallen in water. In such a case, immediately disconnect the AC adapter plug.
  - Make sure that children do not insert any objects in the grooming kit.
  - Turn the hair trimmer off and pull the AC adapter plug out of the socket:
    - after each use,
    - every time after charging it,
-

- if a fault occurs,
- before you connect the charging station with the mains cord,
- before you clean the hair trimmer and the charging station,
- in the event of a storm.



### **Risk of explosion and fire!**

Improper handling of the rechargeable battery poses an increased risk of explosion and fire.

- Protect the rechargeable battery against mechanical damage.
- Never expose the rechargeable battery to excessive heat such as sunlight, fire or similar. The ambient temperature should not fall below or exceed 5–35 °C.
- Only use the original accessories for the charging process.
- Only use the charging station and the adapter plug with the enclosed hair trimmer.

**WARNING!**

**Danger for children and persons with impaired physical, sensory or mental capacities (e.g. partially disabled persons, older persons with reduced physical and mental capacities) or lack of experience and knowledge (e.g. older children).**

- This grooming kit is not intended for use by persons with reduced physical, sensory or mental capabilities, or lack of experience and knowledge, unless they have been given supervision or instruction concerning use of the appliance by a person responsible for their safety. Children must not play with the grooming kit. Cleaning and user maintenance must not be performed by children.
- Keep the hair trimmer, the AC adapter plug and mains cord away from children.
- Do not leave the grooming kit unsupervised while in operation.

- Do not allow children to play with the packaging wrapper. Children may get caught in it when playing and suffocate.
- The pack contents contain small parts. Do not allow children to play with them.



**CAUTION!**

### **Risk of injury!**

Handling the grooming kit improperly may result in injury.

- Do not use the hair trimmer if the trimmer attachment is not firmly mounted.
- Do not use the hair trimmer in the presence of open wounds, cuts, sun burns or blisters.
- When using very narrow attachments, make sure that you do not insert them too far in your nostril or ear lobe.
- Be careful when using the trimmer attachments. They have sharp edges.
- Crushing hazard: Carefully mount the attachments on the hair trimmer. Pay attention to your fingers.

## **NOTICE!**

### **Risk of damage!**

Improper handling of the grooming kit may result in damage.

- To prevent overheating, do not cover the AC adapter plug.
- Do not let the hair trimmer fall down.
- Do not place the grooming kit on hot surfaces or near sources of heat or open flames.
- Do not take the shaving foil out of the shaving foil frame of the shaver attachment and do not clean it with the brush.

## **Checking the grooming kit and pack contents**

## **NOTICE!**

### **Risk of damage!**

If the packaging is opened carelessly with a sharp knife or other pointed objects, you may quickly damage the grooming kit.

### – Be very careful when opening it.

1. Take the grooming kit out of the packaging.
2. Check to make sure that the delivery is complete (see **Fig. A–C**).
3. Check whether the grooming kit or the individual parts exhibit damage. If this is the case, do not use the grooming kit. Contact the manufacturer at the service address specified on the warranty card.

## Charging

### Preparing the charging station

1. Turn the charging station **9** over.

A round opening covered by a locking mechanism is located on the front edge at the bottom of the charging station.

An oval recess **23** for the mains cord **7** of the AC adapter plug **6** is located along the back edge.

2. Push the locking mechanism **22** to the side (see **Fig. F**).
3. Run the mains cord through the oval recess (see **Fig. G**).
4. Insert the barrel plug **8** through the round opening so that the jack extends into the charging station.
5. Then turn the locking mechanism 90 degrees over the barrel plug.

The locking mechanism must noticeably lock into place.



## Charging the hair trimmer

### NOTICE!

#### Risk of damage!

For technical reasons, the capacitance of rechargeable battery will diminish during prolonged periods of storage.

- Avoid prolonged periods of storage and resulting interruption of the charging and discharging cycles.



- **If used regularly**, the charging time for a full rechargeable battery charge amounts to approx. 1.5 hours.
- **The operating time** with a fully charged rechargeable battery amounts to approx. 60 minutes.

1. Place the prepared charging station **9** on a level surface.
2. Insert the AC adapter plug **6** in an easily accessible socket.
3. Place the hair trimmer **1** on the charging station.

The hair trimmer has two LED indicator symbols **2** that provide information about the power supply or the rechargeable battery charge level (see **Fig. A**):

- the battery symbol
- the mains symbol

Symbol	Meaning
Mains symbol illuminated in red	The rechargeable battery is charging.
Mains symbol flashing in red	The rechargeable battery is almost empty and must be charged.
Mains symbol illuminated in red, battery symbol flashing in green	The rechargeable battery is fully charged.
Battery symbol is illuminated in blue	The hair trimmer is operating in battery mode.
No symbol indicator	The hair trimmer is operating in mains mode or has been switched off.

## Operation



### Risk of injury!

Handling the hair trimmer improperly may result in injury.

- If you use the grooming kit in a bathroom, disconnect the AC adapter plug after use. If water is nearby, there is a risk even if the hair trimmer has been switched off.

- As additional protection, it is recommended that you install a residual current protective device (RCD) with a release current of no more than 30 mA in the power circuit. Ask your electrician for advice. Have it installed by an electrical installation technician.



- The hair you intend to trim must be dry.
- The length of the cut may vary depending on the trimming angle.
- Begin with a comb attachment for a longer cutting length and then use progressively shorter cutting lengths as you progress with the haircut.

Irrespective of the charge level of the rechargeable battery, you can use the hair trimmer in mains mode at any time.

1. For mains mode operation, make sure that the hair trimmer **1** is switched off.
2. Take the barrel plug **8** out of the charging station **9**.
3. Insert the barrel plug in the connection point of the hair trimmer.
4. Insert the AC adapter plug **6** in an easily accessible socket.
5. Use the On/Off switch **3** to turn the hair trimmer on.
6. Use the sliding switch **4** for fine adjustment. You can choose from three settings (see **Fig. E**).

## Changing the trimmer attachments



### Risk of injury!

Handling the hair trimmer improperly may result in injury.

- Switch the hair trimmer off before you mount or change the attachments.
  1. To remove and change the trimmer attachments, use your thumb to push the attachment back and off the hair trimmer **1** (see **Fig. D**).
  2. To mount an attachment, run the bottom clip of the attachment into the rail in the hair trimmer.
  3. Push the top part of the attachment on the hair trimmer until it audibly locks into place and is secure.

## Changing the comb attachments

1. To mount the comb attachments **10**, **11**, **12**, **13** and **14**, carefully push the corresponding comb attachment over the trimmer attachment.
2. Push the bottom end of the comb attachment firmly until it locks into place.
3. If you would like to remove the comb attachment, release it on its bottom end.
4. Pull the comb attachment off of the trimmer attachment.

## Choosing the correct attachment

You should choose the attachment that best suits the desired haircut. In addition to scissors **19** for approximate work, the following attachments are also included in the grooming kit:

### Hair trimmer attachment

1. Select one of the four comb attachments **11**, **12**, **13** or **14** that fits the hair trimmer attachment **5**.
2. Thoroughly comb your hair.
3. Wrap a cloth or gown around your neck to prevent hair clippings from falling down your collar.
4. Begin the haircut with the hair trimmer attachment on the neck or the sides and cut towards the middle of the head. Then cut the front part of the hair towards the middle of the head.
5. Hold the hair trimmer **1** so that the comb attachment is flat on the head. Then run it evenly through your hair.
6. If possible, trim the hair against the direction of growth.
7. To ensure that you trim all hairs, run the hair trimmer over the same area of hair several times.
8. If the comb attachment is not mounted, use the hair trimmer only with the hair trimmer attachment for a very short cut.
9. Comb your hair thoroughly again and again.

### Beard trimmer attachment

You can mount the comb attachment for the beard trimmer attachment **10** on the beard trimmer attachment **16**.

You can choose from 4 different cutting lengths with the comb attachment for the beard trimmer attachment. The numbers 3, 4, 5, 6 correspond to the cut lengths in mm with the fine setting level 1 (sliding switch for fine adjustment **4** at the very bottom). With the fine setting level 3 (sliding switch for fine adjustment at the very top), the configured cut length is reduced by approx. 0.5 mm depending on the trimming angle.

1. Comb the beard in the direction of growth.
2. Cut the beard downwards from the ear to the chin. First trim one and then the other side.
3. Use the beard trimmer attachment without the comb attachment to trim the beard very short or the moustache and contours. The cutting edge of the beard trimmer attachment is pointed towards the beard at a right angle.
4. Push the comb attachment so that the desired cut length locks into place under the arrow mark.
5. Place the comb attachment with the rounded side up against the beard and, from below, cut upwards against the direction of beard growth.
6. To cut your moustache, first comb it straight down. Then use either the beard trimmer attachment or the contour trimmer attachment **15**. Start in the middle above your mouth and trim one side and then the other.

## Contour trimmer attachment

1. Use the contour trimmer attachment **15** to shorten and shape your moustache, whiskers, sideburns or eye brows.
2. Position the edge of the attachment at the desired height of the hair line and move the hair trimmer down.

## Shaver attachment



Your skin must be clean and dry.

1. Select the shaver attachment **18**.
2. Hold the hair trimmer **1** at a right angle to the surface of your skin and gently run it over your face.
3. Shave against the direction of beard growth.
4. In complicated areas, like your chin, stretch your skin for better results.

## Nose/ear hair trimmer attachment

### NOTICE!

### Risk of damage!

Improper handling of the hair trimmer may result in damage.

- Do not use the fine adjustment when working with the nose/ear hair trimmer attachment.
1. Slowly run the metal tip of the nose/ear hair trimmer attachment **17** into a nostril or ear.
  2. Set the sliding switch for fine adjustment **4** to level 1 (bottom).
  3. Slowly move the hair trimmer **1** in circles to cut the hair.

## Cleaning



**CAUTION!**

### **Risk of injury!**

Handling the hair trimmer improperly may result in injury.

- Pull the AC adapter plug before you clean the hair trimmer or charging station.

**NOTICE!**

### **Risk of short circuit!**

Water that has penetrated the housing may cause a short circuit.

- Do not immerse the hair trimmer, the charging station or AC adapter plug in water.

**NOTICE!**

### **Risk of damage!**

Improper handling of the hair trimmer may result in damage.



- Do not use any aggressive cleaners, brushes with metal or nylon bristles, sharp and metallic cleaning utensils such as knives, hard scrapers and the like. They could damage the surfaces.



Clean the grooming kit and the attachments used after every use.

## **Cleaning the charging station**

1. Pull the AC adapter plug **6** and the barrel plug **8** out before cleaning.
2. Use a damp cloth to wipe off the charging station **9**. Then let it dry completely.

## **Cleaning the comb attachments**

1. Remove the comb attachment.
2. Rinse the comb attachment off with water and let it dry completely.

## **Cleaning the hair, beard and contour trimmer attachment**



**CAUTION!**

### **Risk of injury!**

You could injure yourself if you handle the blade oil improperly.

- Keep the blade oil bottle out of the reach of children.
- Do not allow the blade oil to come into contact with your eyes. However, if blade oil does end up in your eyes, immediately rinse the blade oil out of your eyes with plenty of water. Consult a physician.
- Blade oil must not be swallowed.
  1. Use your thumb to push the attachment back and off the hair trimmer **1**.
  2. Use the enclosed cleaning brush **20** to remove any leftover hair from the attachment.
  3. Apply a few drops of blade oil **21** to the cutting edge of the attachment. If applicable, use a soft cloth to wipe excess blade oil off. Only use blade oil that does not contain acid, e.g. sewing machine oil.

## Cleaning the shaver attachment

### NOTICE!

#### Risk of damage!

Improper handling may result in damage to the hair trimmer.

- Do not take the shaving foil out of the shaving foil frame.
- Do not clean it with the brush.



- When mounting it, make sure that the fastening clips on the shaving foil frame fit into the corresponding recesses on the shaver attachment. Gently push the shaving foil frame down until it audibly locks into place.
  - From time to time, apply a few drops of acid-free blade oil (e.g. sewing machine oil) to the shaver blade. Place the shaver attachment on the hair trimmer and let it run for a few seconds without using it. If applicable, use a soft cloth to wipe excess blade oil off.
1. Take the shaver attachment **18** off.
  2. Push the buttons on the side of the shaver attachment and pull the shaving foil frame off. In the process, only hold the shaving foil frame by the sides and do not press down on the shaving foil.
  3. Clean the shaver blade with the enclosed cleaning brush **20**.

4. Clean the shaving foil in the shaving foil frame under running water and let it dry completely before putting it back on the shaver attachment.
5. Place the shaving foil frame back on the shaver attachment.

## Cleaning the nose/ear hair trimmer attachment

1. Take the nose/ear hair trimmer attachment **17** off.
2. Rinse it off with water and let it dry completely before reusing it.

## Troubleshooting

Problem	Possible cause	Solution
The hair trimmer is not working.	The rechargeable battery is empty.	Use the hair trimmer in mains mode.
		Charge the rechargeable battery.
	The AC adapter plug has not been properly inserted in the socket.	Insert the AC adapter plug properly in the socket.

Problem	Possible cause	Solution
The rechargeable battery is not charging although the hair trimmer is on the charging station.	There may be a contact problem with the barrel plug.	Make sure that the hair trimmer is carefully positioned on the barrel plug mounted in the charging station. Check the charge indicator light (mains symbol must be red).
The trimmer attachments do not exhibit proper mobility.	The trimmer attachments are soiled.	Clean and oil the trimmer attachments.

## Travel guard

The hair trimmer is equipped with a travel guard that prevents the hair trimmer from accidentally activating.

### Activating the travel guard

- Hold the On/Off switch **3** down for approx. 3 seconds. The hair trimmer **1** will automatically deactivate and the battery symbol will flash twice in green.  
The travel guard is now active.

## Deactivating the travel guard



Connecting the hair trimmer with the barrel plug and inserting the AC adapter plug in a socket will automatically deactivate the travel guard.

1. Hold the On/Off switch **3** down for approx. 3 seconds. The battery symbol will flash green and then illuminate in blue.

The hair trimmer will now automatically switch on.

2. Briefly push the On/Off switch to turn the hair trimmer off. The travel guard is now deactivated.

## Storage

- Store the hair trimmer **1** in a dry area with a suitable temperature.
- When storing the product for prolonged periods, we recommend you use the original packaging.

## Technical data

Model:	18163902 / 18163903
Article number:	96607
Weight:	approx. 400 g
Dimensions:	approx. 4 × 3.7 × 16.3 cm
Output:	5 W

**AC adapter plug**

Input voltage:	100–240 V ~ 50/60 Hz, 0.2 A max.
Output voltage:	5.0 V $\equiv$ , 1,000 mA
Protection class:	II
Ambient conditions:	only permitted for indoor areas

**Hair trimmer**

Input voltage:	5.0 V $\equiv$ , 1,000 mA
Rechargeable battery:	1 x Li-Ion 3.7 V 14430 500 mAh
Protection class:	III
Ambient temperature:	+5 °C to +35 °C

**Declaration of conformity**

The EU declaration of conformity can be requested from the address specified on the enclosed warranty card.

**Disposal****Disposing of the packaging**

Dispose of the packaging separated into single type materials. Dispose of cardboard and carton as waste paper and foils via the recyclable material collection service.

## Disposing of the grooming kit

(Applicable in the European Union and other European states with systems for the separate collection of reusable waste materials)

### Old devices must not be disposed of with household waste!



If the grooming kit is no longer operational, every consumer is **required by law to dispose of used devices separately from household waste**, e.g. at a collection point run by the local authority or borough. This ensures that old appliances are recycled in a professional manner and also rules out negative consequences for the environment. For this reason, electrical equipment is marked with the symbol shown here.

### Batteries and rechargeable batteries do not belong in the household waste!



As the end user you are required by law to bring all batteries and rechargeable batteries, regardless whether they contain harmful substances\* or not, to a collection point run by the local authority or borough or to a retailer, so that they can be disposed of in an environmentally friendly manner.

Dispose of the entire grooming kit (including the battery) at your collection point in a discharged state only!

\*labelled with: Cd = cadmium, Hg = mercury, Pb = lead





Great care has gone into the manufacture of this product and it should therefore provide you with years of good service when used properly. In the event of product failure within its intended use over the course of the first 3 years after date of purchase, we will remedy the problem as quickly as possible once it has been brought to our attention. In the unlikely event of such an occurrence, or if you require any information about the product, please contact us via our helpline support services, details of which are to be found both in this manual and on the product itself.



### **PRODUCED IN CHINA FOR:**

ALDI STORES LTD. PO BOX 26, ATHERSTONE  
WARWICKSHIRE, CV9 2SH

---

ALDI STORES (IRELAND) LTD.  
PO BOX 726, NAAS, CO. KILDARE.  
Visit us at [www.aldi.com](http://www.aldi.com)

#### **AFTER SALES SUPPORT**

96607



**00800 - 09 34 85 67**



**[www.zeitlos-vertrieb.de](http://www.zeitlos-vertrieb.de)**

MODEL:

18163902 / 18163903

11/2018

**3**

**YEAR  
WARRANTY**